

LI- J1010-FEEDTHROUGH

Precision is
our business



APPLICATION

CMS has available a wide range of products of quartz glass light guides. The LI-J1010-FEEDTHROUGH light guide is assembled by one single fibre with 600 μ m diameter.

The end is terminated with an SMA connector and a SMA socket. A flexible part allows an easy connection to other systems.

Different types and length are available on request.

SPECIFICATION

Acceptance cone angle 25°

Material Suprasil® 200 nm up to the NIR

Material Infrasil® 350 nm up to 2400 nm

Physical data

Single fibre diameter 600 μ m (standard SMA) others on request

Length 70 mm

Mechanical connector SMA and SMA socket; others on request

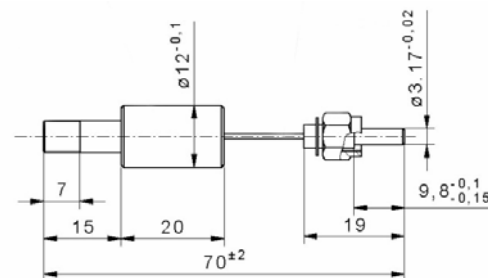

CMS - Ing. Dr. Josef Schreder
Eggerstrasse 8
6322 Kirchbichl
AUSTRIA

Tel: 0043 / (0)5332 / 77056

Fax: 0043 / (0)5332 / 76692

E-Mail: info@schreder-cms.com